



STUDIO 8

Operation Department.
Camera and Lighting Section

Studio Dimensions

structural Dimensions:
(L:20 m, W:14.85 m, H:8 m)

Lighting grid height 6m

Effective Dimensions:
(L:17 m, W:11.85 m, H:4.5 m)

Drawn By: Hesham Alyaseen.

Date: 18/11/2023

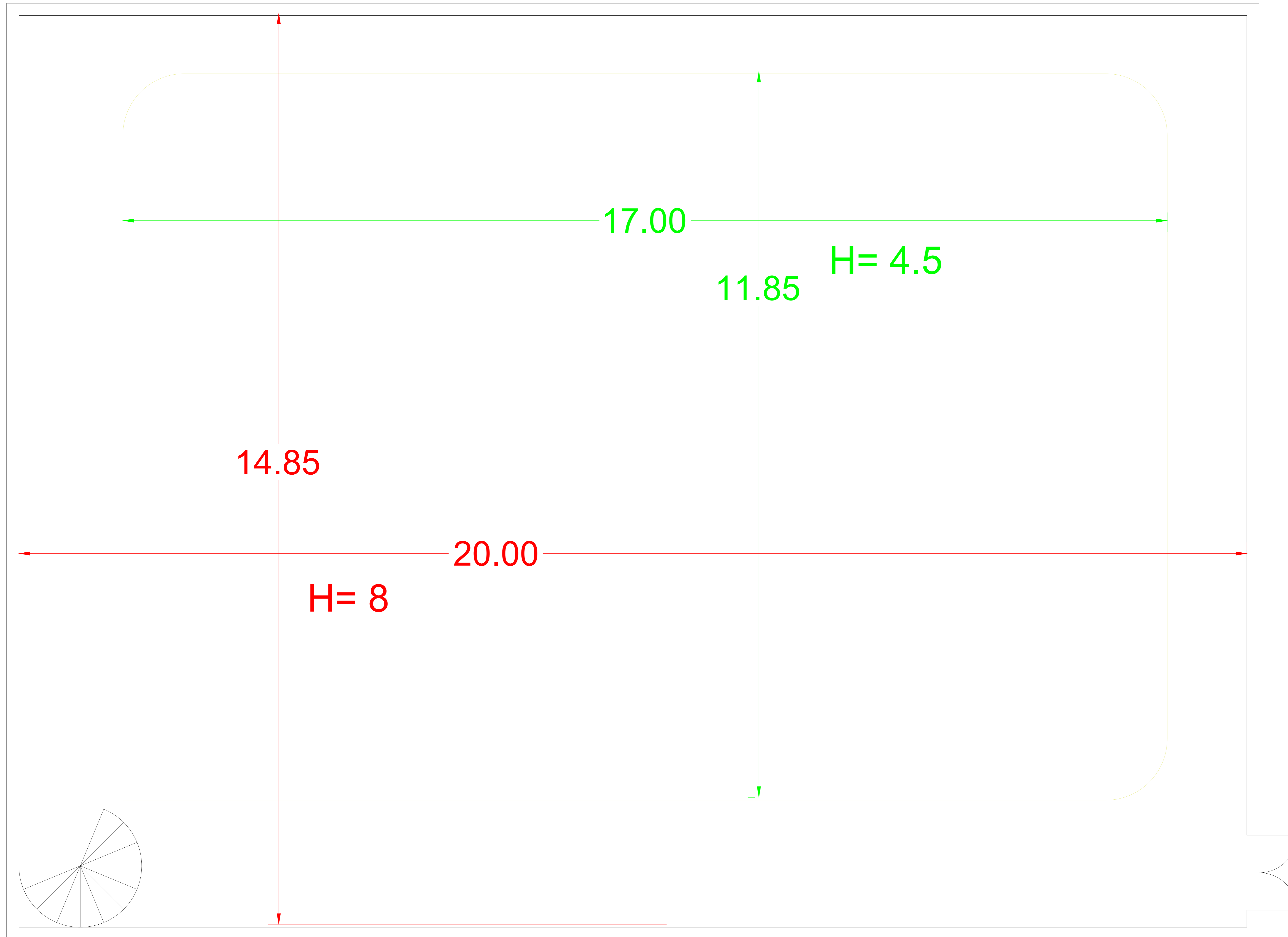

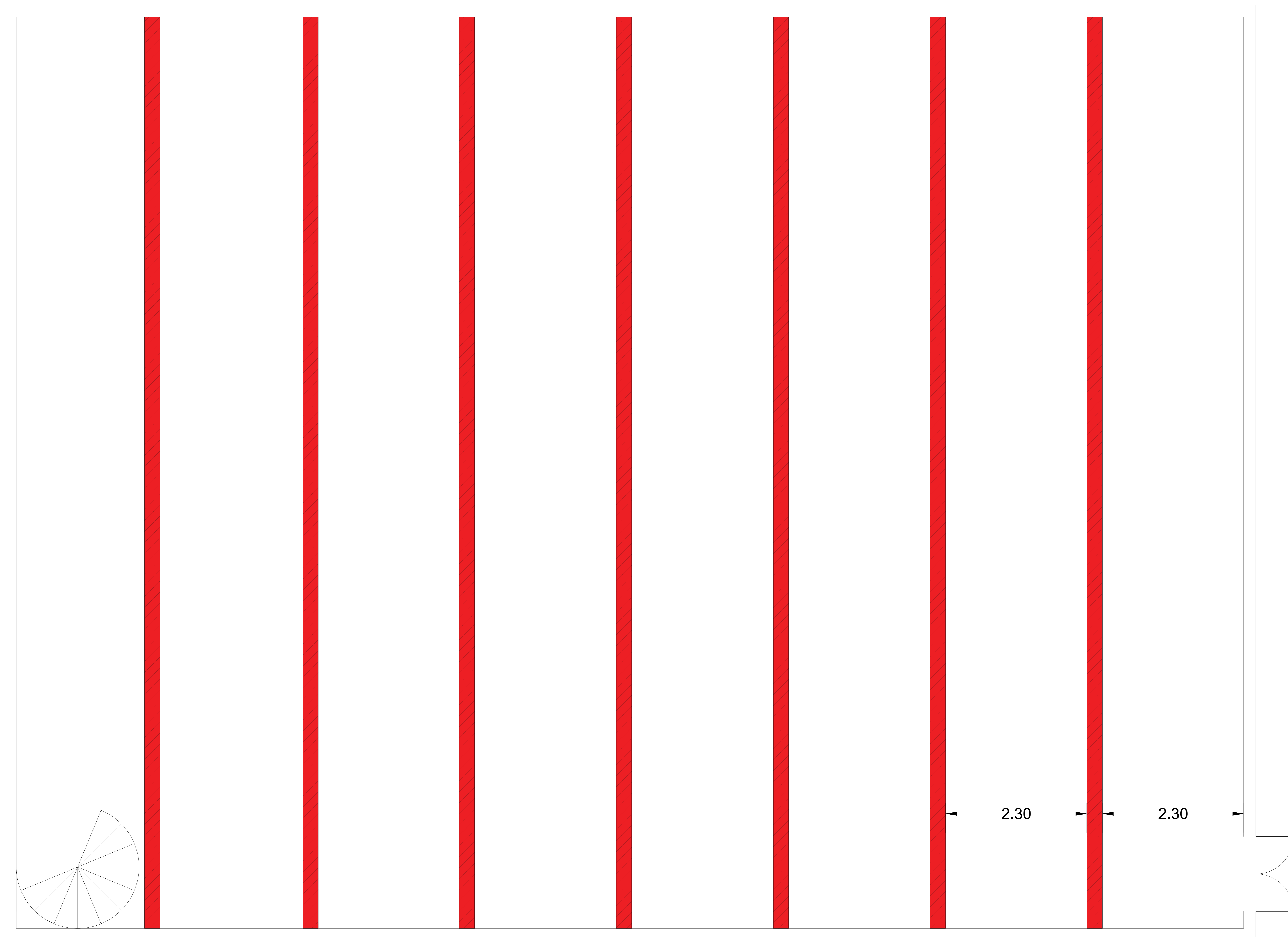

STUDIO 8

Operation Department.
Camera and Lighting Section

I beams Layout

Number of Beams :7

Beam to Beam Distance: 2.3m

Drawn By: Hesham Alyaseen.

Date: 18/11/2023

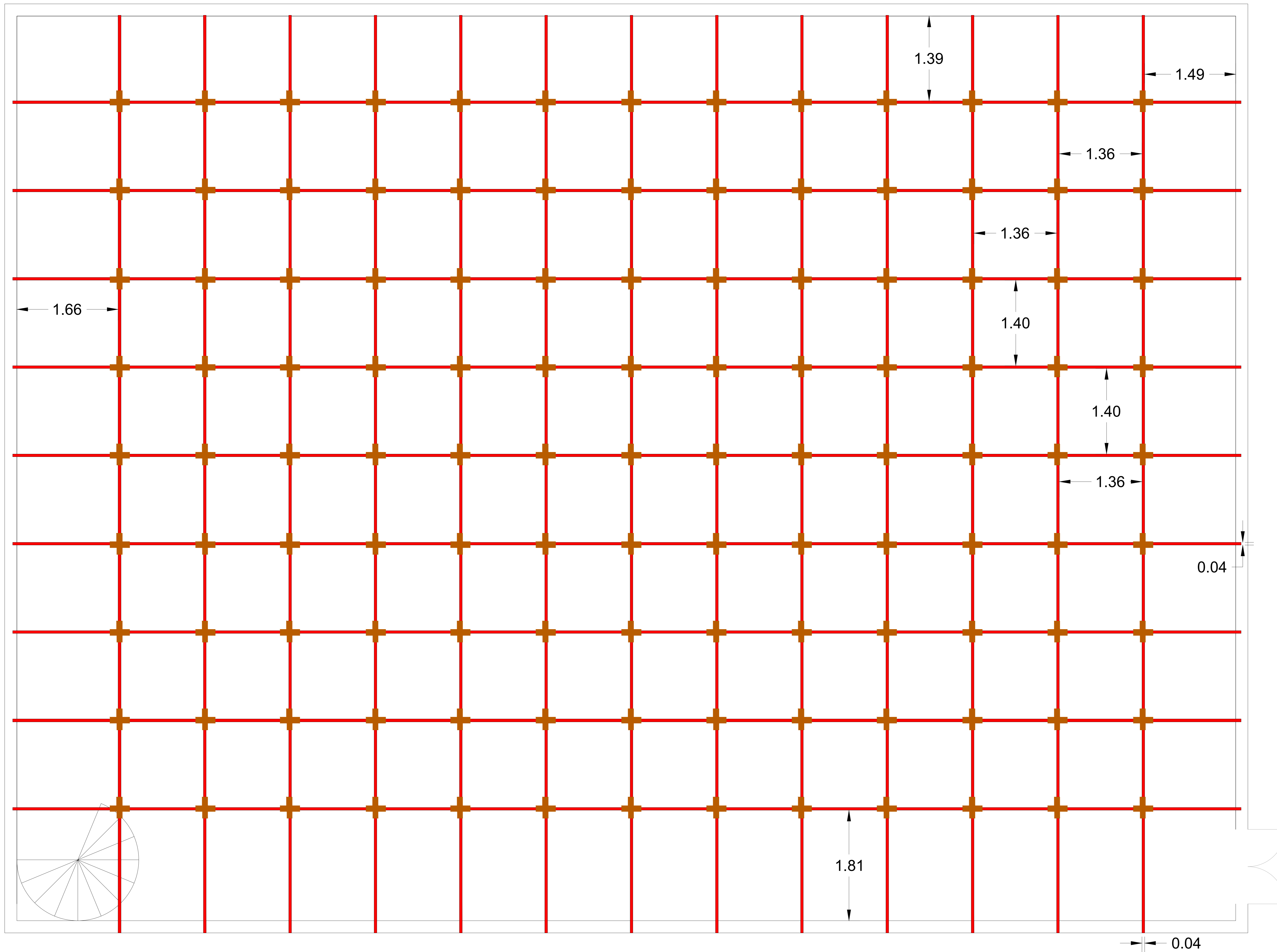

STUDIO 8
Operation Department. Camera and Lighting Section
Lighting Beams Grid
Number lighting Grid beams (7*13)
Pipe Diameter (0.06 m)
pipe separation (1.40*1.36) m
Drawn By: Hesham Alyaseen.
Date: 16/11/2023



STUDIO 8

Operation Department.
 Camera and Lighting Section

Power Panel Layout

Power panels on grid level (G.L) 21
 power panels on floor level (F.L) 11

Number Of 3KW socket 62

Number Of 5KW socket 26

Number Of 10KW socket 4

Number of Channels 92

Channel Number (C. N)

Number of direct panel 10

Drawn By: Hesham Alyaseen.

Date: 16/11/2023

